

Multi-Faith Centre

Ensuring a compliant, maintainable low or zero carbon energy design is embedded from first principles.

PASSIVHAUS
MULTI-FAITH CENTRE
OFFERING SPACE FOR ALL

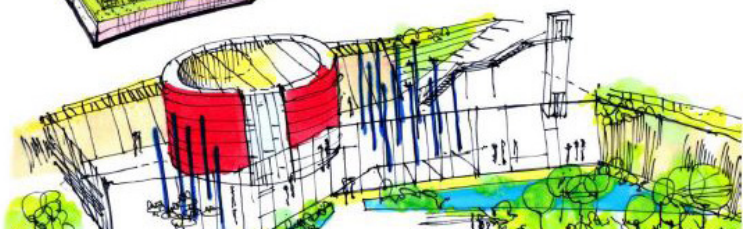
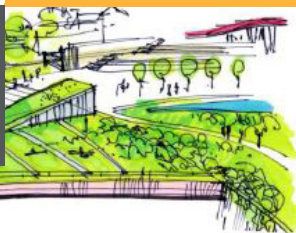

Description

- Working as a multi-discipline design team to create a passivhaus multi-faith centre for the University of Exeter
- The centre will provide a more cohesive set of facilities for the chaplaincy team and other faith groups
- The new space will enable a place that encourages community and discussion where different faith members are able to participate in a mutually respectful, yet co-operative, manner
- It will connect to the natural environment through framed views and materiality. The building demonstrates zero carbon sustainable design as an educational tool
- Project currently at RIBA Stage 3.

Involvement

- Full MEP building services design through the architectural RIBA stages of work
- Energy in use reduction including Passivhaus type calculation methods to advise on thermal bridging, and reduction of heat transfer
- Façade optimisation enabling window & glazing types testing, fabric air permeability and potential for natural ventilation
- Testing of different building forms on passive reduction in solar gain
- Overheating risk assessments and thermal comfort studies
- Energy compliance modelling and thermal bridging calculation and assessment
- Low and zero carbon energy assessment.

Benefits Delivered

- Key understanding of project design teams
- Digitally draughted in Autodesk 3D Revit to deliver a coordinated detailed design
- Methodical communication of specific low energy design elements to appropriate people (i.e BREEAM, Passivhaus, Part L2 compliance or another framework)
- Early review of building fabric and form, feedback on architectural room data sheets and associated energy-efficient building services systems. Proactive approach continued through design to construction phase
- Reduced potential for additional works via facilitation of a clear and concise design path.